



Ground floor in San Luis, Menorca

Ref.: 91474

Commercial premises with a conversion project into a residence in the charming village of Sant Lluís, set in an area with all amenities and shops within easy reach. The project, already submitted to the Town Hall, proposes a contemporary and well-planned layout, featuring a generous open-plan living space with lounge, dining area and integrated kitchen, a bedroom with dressing area, two fully fitted bathrooms and a garage. An excellent opportunity to create a stylish and comfortable home, where design and practicality come together in a single space, in a setting with excellent connect



Price: 275.000 €

	Cons.	Emis.
A		
B		
C	47.4	12
D		
E		
F		
G		

The information provided has been supplied by third parties for informational purposes only and is deemed to be correct. However, it may be subject to errors, price changes, and withdrawal from the market without prior notice.

*The stated prices do not include applicable VAT or Property Transfer Tax (ITP), nor notary and land registry fees.

**In the case of new developments, the applicable taxes will be 10% VAT + 1.5% Stamp Duty (AID), in addition to notary and land



The information provided has been supplied by third parties for informational purposes only and is deemed to be correct. However, it may be subject to errors, price changes, and withdrawal from the market without prior notice.

*The stated prices do not include applicable VAT or Property Transfer Tax (ITP), nor notary and land registry fees.

**In the case of new developments, the applicable taxes will be 10% VAT + 1.5% Stamp Duty (AID), in addition to notary and land

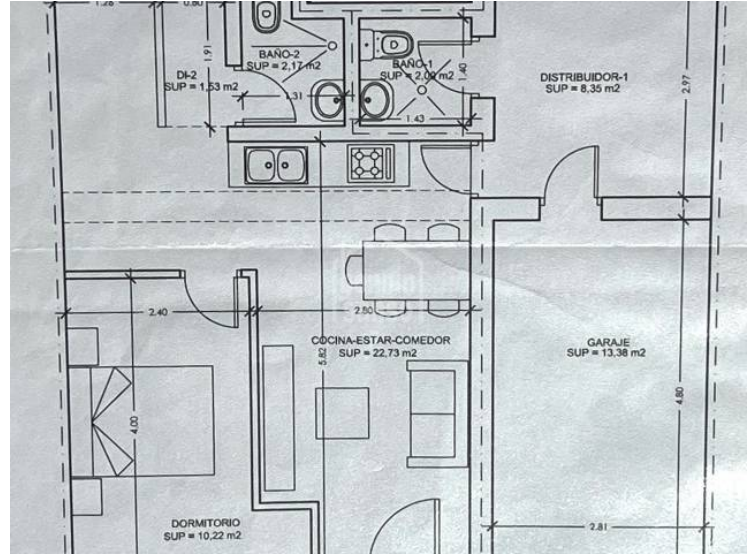

The information provided has been supplied by third parties for informational purposes only and is deemed to be correct. However, it may be subject to errors, price changes, and withdrawal from the market without prior notice.

*The stated prices do not include applicable VAT or Property Transfer Tax (ITP), nor notary and land registry fees.

**In the case of new developments, the applicable taxes will be 10% VAT + 1.5% Stamp Duty (AID), in addition to notary and land